



# GENUINE PARTS

## INSTALLATION INSTRUCTIONS

<b>DESCRIPTION:</b>	Splash Guard Kit - Front
<b>APPLICATION:</b>	JUKE
<b>PART NUMBER:</b>	999J2 6Z003

KIT CONTENTS:			
Item	Qty.	Part Description	Service Part Number
A	1	Splash Guard - Front Left	999J2 6Z005
B	1	Splash Guard - Front Right	999J2 6Z006
C	2	Push Pin (Long)	11296 AG000
D	2	Push Pin (Short)	01553 05323
E	2	Screw	01451 00891
F	1	Installation Instruction Replacement Template	N/A

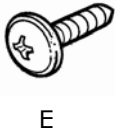
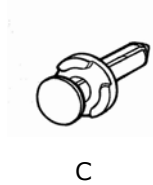
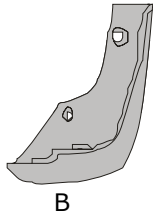
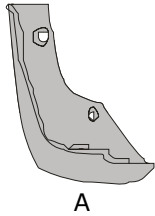

- TOOLS REQUIRED:**
- #2 Phillips screwdriver
  - Clip remover
  - Drill
  - 8mm (5/16") Drill Bit
  - Clean, lint-free wiping cloth
  - Soap & water
  - Jack

- PRE-INSTALLATION WARNINGS, CAUTIONS, CRITICAL STEPS, and NOTES:**
- Dealer Installation Recommended.
  - These instructions are for left side of vehicle; same procedure applies to right side.
  - Jack up vehicle using instructions under "Changing Tire" section of owner's manual.

## INSTALLATION PROCEDURE:

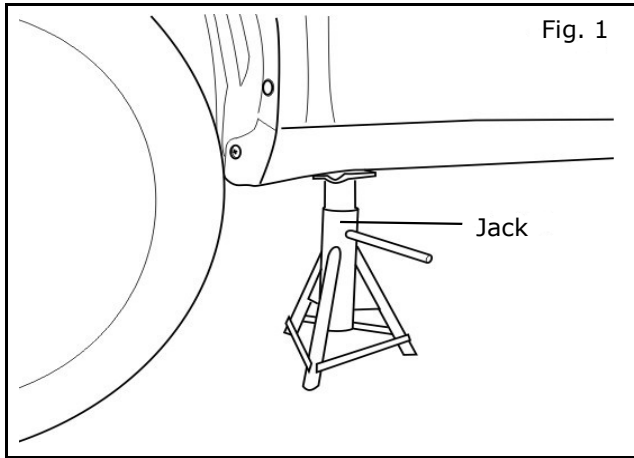

- 1) Turn the tire to the left.
- 2) Jack up vehicle.

### NOTE:

Jack up vehicle using instructions under "Changing Tire" section of owner's manual.

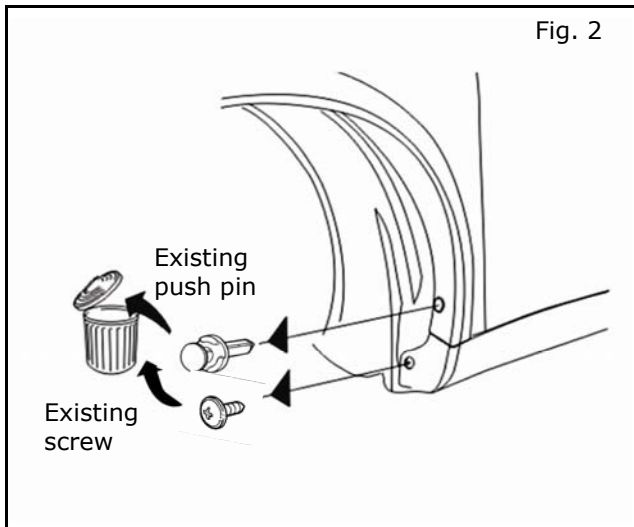

- 3) Remove and discard existing push pin.
- 4) Remove and discard existing screw.

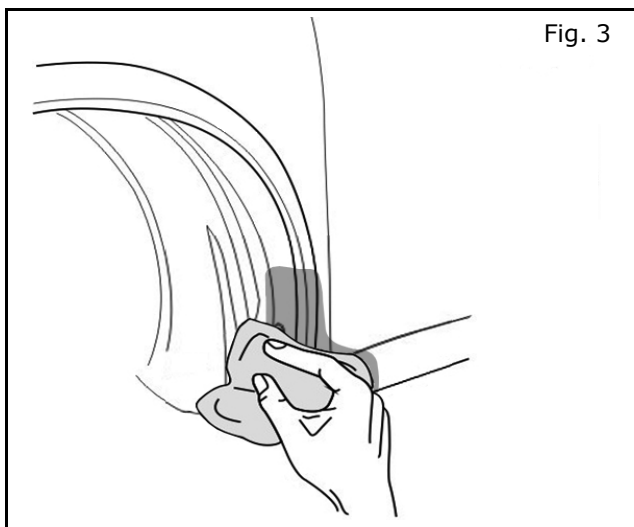

- 5) Clean installation surface (shaded area) with soap & water.

## INSTALLATION PROCEDURE:

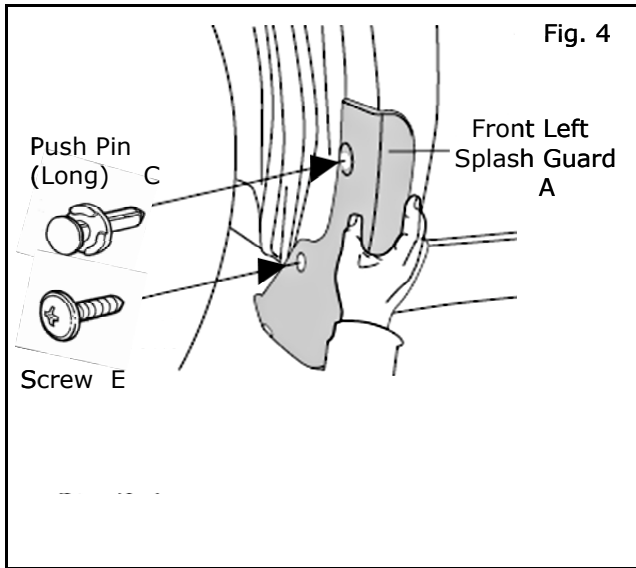

- 6) Align splash guard to vehicle.
- 7) Install push pin (long) C.

### NOTE:

- Hold Splash Guard tight to vehicle while tightening screws to ensure no gap occurs between Fender and Splash Guard.
- Do not over tighten screws. Reference Tighten Torque: 3.8~4.4 N-m {34~39 in-lb}

- 8) Install screw E.

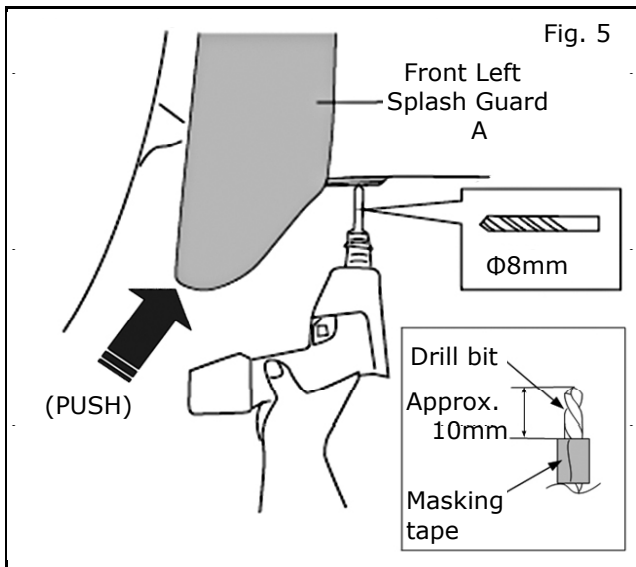

- 9) Push splash guard lightly to vehicle and confirm no gaps.
- 10) Drill 8mm hole.
- 11) Install push pin (short) D.

